

● Features:

- * On steam service, the syphon will prevent hot steam from entering a pressure gauge, diaphragm seal or transmitter
- * Available in brass/steel for non-corrosive applications and stainless steel for corrosive applications

● Applications:

- * Recommended for applications involving temperatures above 100°F (37°C)

Specifications	
Material	Ss316, SS304, Brass or Black Steel
Shape	180° coil
Connection	1/4"NPTM x 1/4"NPTM, 1/2"NPTM x 1/2"NPTM, 1/4"NPTM x 1/4"NPTF, 1/2"NPTM x 1/2"NPTF
Size	φ60×170mm, φ100×230mm

● ASP Series Product Code

Syphon Type	SS 304	SS316	Black Steel
1/4"NPTM x 1/4"NPTM	SS41	SS61	BS01
1/2"NPTM x 1/2"NPTM	SS42	SS62	BS02
1/4"NPTM x 1/4"NPTF	SS43	SS63	BS03
1/2"NPTM x 1/2"NPTF	SS44	SS64	BS04

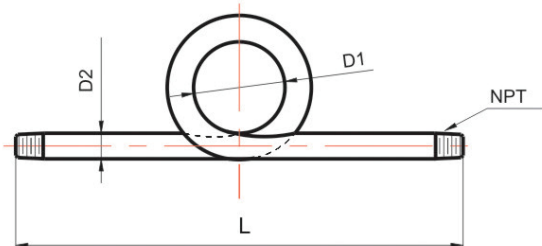

NPT Connection	L	D 1	D 2
1/4" NPTM x 1/4" NPTM	7.087" (180mm)	1.969" (50mm)	0.551" (14mm)
1/2" NPTM x 1/2" NPTM	8.661" (220mm)	2.205" (56mm)	0.827" (21mm)

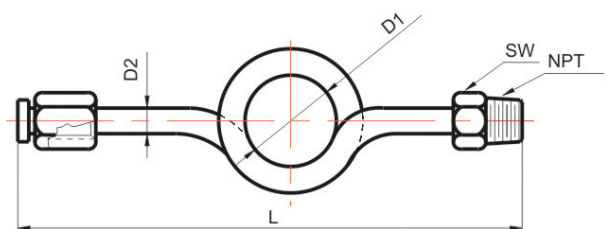

NPT Connection	L	D 1	D 2	SW
1/4" NPTF x 1/4" NPTM	9.055" (230mm)	1.969" (50mm)	0.394" (10mm)	0.866" (22mm)
1/2" NPTF x 1/2" NPTM	9.449" (240mm)	1.969" (50mm)	0.394" (10mm)	1.063" (27mm)